

# JPF-75 Series HEAVY DUTY FLOOR SPRING

## JPF-75 HEAVY DUTY FLOOR SPRING

is a double action floor spring which specially developed for heavy wooden, metal aluminum & toughened tempered glass door industries.

This Floor Spring is designed for special application multi-functional for door with 180° opening angle, and weight up to 300 kgs.

## FEATURES & SPECIFICATION

- Length 308 mm x width 105 mm x depth 50 mm
- Suitable for single & double action doors.
- Maximum door opening angle at 180° in each direction.
- Maximum door weight 200 kgs. Maximum door width 1200mm.
- Cam system for easy door open.
- Available for Hold-Open 90°, 105°, and No-Hold Open
- For Fire Door, it must be in Non-Hold open type.
- Closing and latching speed controlled by the fully independent valves ( closing from 180° ~ 15° , latching from 15° ~ 0° )

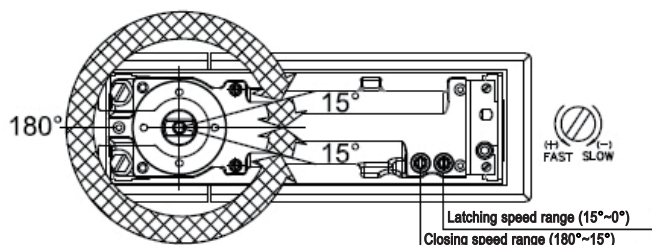

- The Spindle optional : Fixed and Exchangeable Spindle available.

### Exchangeable spindle extension:

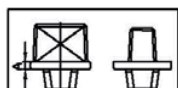

Dimension (A)	3mm	8mm	13mm	18mm	23mm	28mm	33mm	38mm	43mm	48mm	53mm
Spindle Extension	Standard	5mm	10mm	15mm	20mm	25mm	30mm	35mm	40mm	45mm	50mm

## TECHNICAL DATA

Closing size	Closing Force	Max. Door Width	Max. Door Weight
EN2	20~25 Nm	900 mm	100 kgs
EN3	25~33 Nm	1050 mm	150 kgs
EN4	33~36 Nm	1200 mm	200 kgs

## CONSTRUCTION & TECHNICAL DETAILS

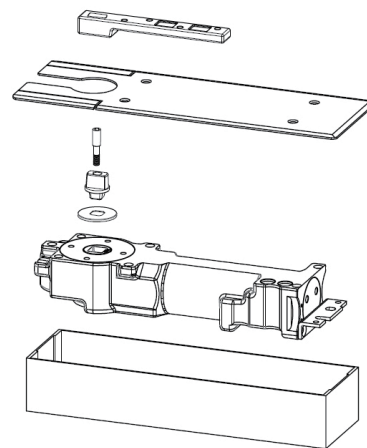

- Dimension of Cement Case : ( L ) 285x ( W ) 82 x ( H ) 50mm
- Adjustment in cement box : ( L ) 8 mm x ( W ) 10 mm
- Dimension of Cover Plate : ( L ) 308 mm x ( W ) 105mm
- Stainless Cover Plate with Polished or Satin finished.
- High grade cast iron mechanism body is housed within a galvanized steel loose box which is zinc protected & panited for corrosion resistance.
- Total mechanism immersed in high quality hydraulic fluid ensure smooth operating even under differing temerature conditions.
- Internal mechanism components utilizing heat treated high alloy steels & ball bearing for optimum efficiency.
- Built-in pressure relief valves protect the closer from oil-leakage.
- Speed adjustment valves can not be backed out of Floor Spring when adjustment, that eliminates oil leakage from the valves.